



OWNER'S MANUAL

12V or 24V Submersible Pump Kit

50040
12V Pump
50041
24V Pump

August 2022

Description

The EL Series 50040 / 50041 12V / 24V Submersible Pump Kit is designed for transferring diesel or water in a submerged environment for quick transfer jobs. The kit comes complete with pump, 4 metres of 3/4" ID rubber hose, manual nozzle and 4 metres of battery cable and clamps. The pump is capable of delivering flow rates of up to 32 litres per minute with a 30 minute duty cycle and has a working life of approximately 500 to 600 hours. The pump has the latest aluminium alloy shell with shell thickness increased making the housing stronger and which also helps protect the casing from rust and corrosion. The base of the filter has a stainless steel screen filter which assists in keeping the diesel or water free from contamination.

The new 50040 / 50041 12V / 24V Submersible Pump Kit is suitable for transferring diesel, oil up to SAE20, AFT or fresh water and is widely used in a variety of industries including boating & fishing, farming & agriculture, transport, & construction.

Specifications

Uses:	Transferring diesel, oil up to SAE20, ATF or fresh water and is widely used in a variety of industries including mining, construction, agriculture, transport and fishing
Discharge Quantity:	Up to 32L/min
Materials:	Aluminium alloy shell
Motor Speed:	8700R/min
Rated Voltage:	12V Pump maximum load current of 8A power 96W 24V Pump maximum load current of 5A power 110W
Pump Life:	Approximately 500-600 hours
Delivery Cycle:	30 minute

- 1 The pump should be clean and flushed to eliminate any contamination before submersing completely into the clean oil (or water).
- 2 After use, the pump should be removed from the oil (or water).
- 3 The DC Volt motor is fast with low noise.
- 4 Good seals ensure no leakage prolonging the service life.
- 5 With the latest aluminium alloy shell, shell thickness is increased making the housing stronger and harder to deform. The aluminium alloy shell prevents the casing from rust and corrosion.
- 6 At the base of the pump is a stainless steel filter screen preventing contamination. The filter is threaded for convenient disassembly, repair and replacement.
- 7 Power supply comes with a second midway switch for convenient operation.
- 8 Pump outlet diameter 19.5mm, delivers up to 30L/min.
- 9 Outlet diameter of the oil hose 19mm-20mm.
- 10 The pump is suitable for transferring diesel, oil up to SAE20, ATF, petrol, kerosene, alcohol or water.

Cautions

- When pumping diesel, petrol, kerosene, alcohol or any other flammable liquids! Open the nozzle before using the pump. Stem and pump with no-load operation.
- Before use confirm whether the power and pump labelling voltage line has a voltage tolerance of $\pm 5\%$. Note the positive and negative pole.



NSW/ACT
TEL: (02) 9677 1555
FAX: (02) 9675 1155

QLD/PNG
TEL: (07) 3204 9166
FAX: (07) 3204 1224

VIC/TAS
TEL: (03) 8787 8288
FAX: (03) 8787 8266

WA
TEL: (08) 9302 4199
FAX: (08) 9303 2095

SA/NT
TEL: (08) 8241 7111
FAX: (08) 8241 7011

NZ
TEL: (09) 447 1007
FAX: (09) 447 1008

Parts & Drawing Breakdown 50040 /50041

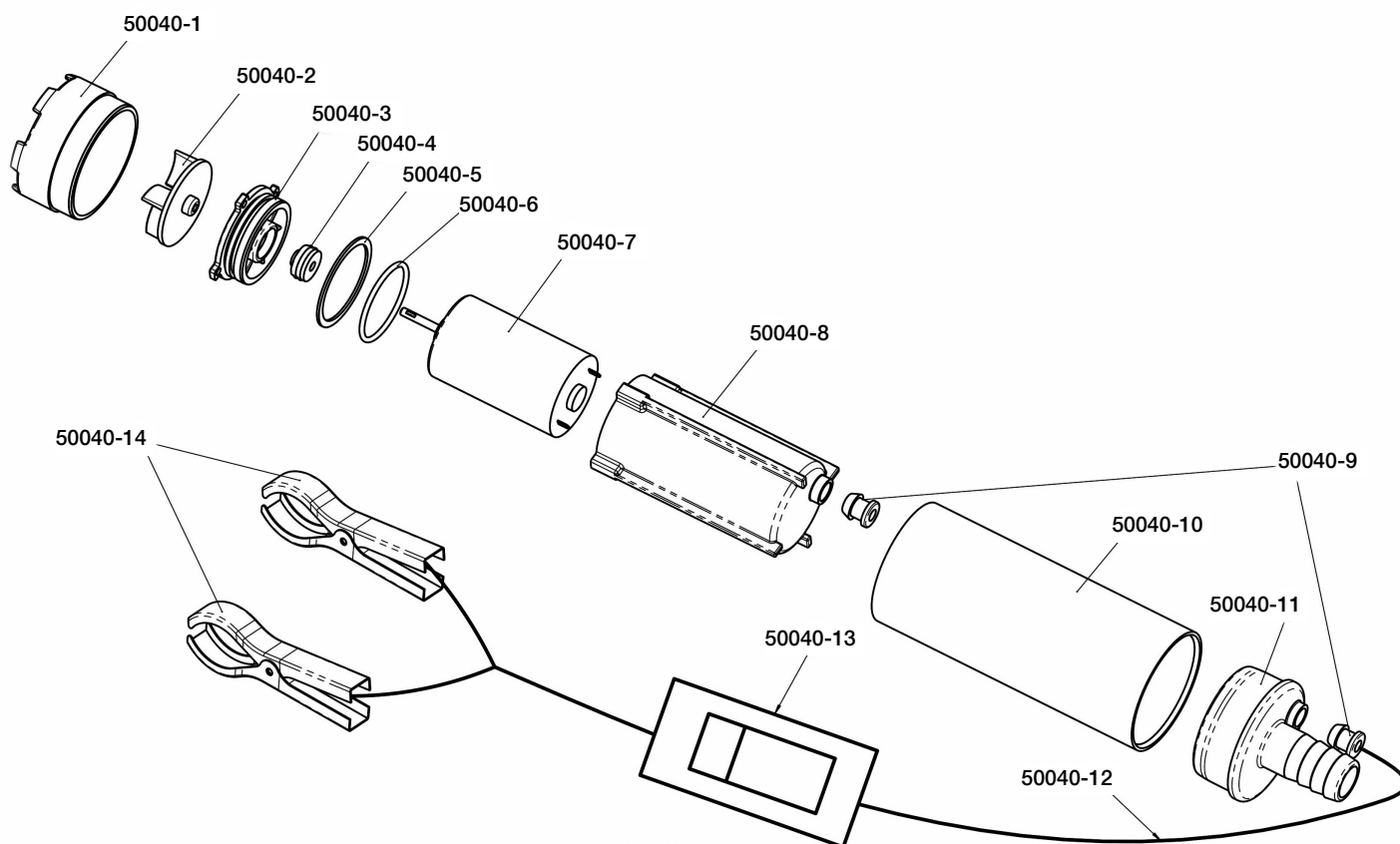

Ordering Spare Parts

Parts List – Part No. 50040

Part No.	Description	Qty
50040-1	Oil Filter	1
50040-2	Wind Leaf	1
50040-3	Motor Seal Cover	1
50040-4	Lock Ring	1
50040-5	Sealing Gasket	1
50040-6	O-Ring	1
50040-7	Motor	1
50040-8	Motor Insulation Cover	1
50040-9	Seal Cartridge	2
50040-10	Aluminium Alloy Shell	1
50040-11	Oil Cover	1
50040-12	Two Core Power Line	1
50040-13	Midway through the Switch Gear	1
50040-14	Positive and Negative Battery Clip	2

Technical Parameters

Voltage: 12V
Maximum Current: 8A
Power: 96W
Traffic: 32L/min

Voltage: 24V
Maximum Current: 5A
Power: 120W
Traffic: 32L/min

NSW/ACT
 TEL: (02) 9677 1555
 FAX: (02) 9675 1155

QLD/PNG
 TEL: (07) 3204 9166
 FAX: (07) 3204 1224

VIC/TAS
 TEL: (03) 8787 8288
 FAX: (03) 8787 8266

WA
 TEL: (08) 9302 4199
 FAX: (08) 9303 2095

SA/NT
 TEL: (08) 8241 7111
 FAX: (08) 8241 7011

NZ
 TEL: (09) 447 1007
 FAX: (09) 447 1008