



PRODUCT INFORMATION

May 2013



SHF-N-525

Coxreels 3/4" ID Petrol & Diesel Spring Rewind Hose Reel

The Coxreels SHF-N-525 spring rewind hose reel has a history of dependable performance. The larger chassis and frame accommodate longer lengths and larger diameters of hose. A dual axle support system increases the stability during operation, reduces vibration and strengthens the structural integrity of the reel. Supplied standard with 8m x 3/4" ID hose the SHF-N-525 has a pressure rating of up to 300 psi.

Auto rewind easily wraps, stores & protects the hose effectively offering a longer service life. Signature features of the SHF-N-525 3/4" ID spring rewind hose reel include professional grade heavy duty steel construction, rolled edges and ribbed disc providing strength and safety, durable, powder coat finish and multi-position lock ratchet to secure the hose at any desired length. Antistatic hose suitable for petrol and diesel.

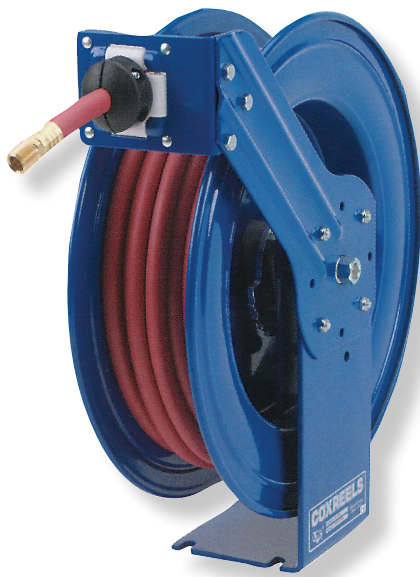

PRODUCT SPECIFICATIONS, FEATURES AND BENEFITS

Dual axle support points to the centre shaft with Coxreels' original super hub™ axle support system

8m x 3/4" ID hose

Pressure of up to 300 psi

Swivel seals: nitrile

Auto rewind easily wraps, stores & protects hose

Heavy gauge 1/4" steel base & support post

Factory-matched cartridge-style spring motor

Solid machined brass swivel

1" solid steel axle with 1" lubricated precision bearings

Guide arm adjusts to wall, floor & overhead positions

Multi-position lock ratchet secures hose at the desired length

Non-corrosive stainless steel spring, pawl & zinc plated ratchet

Professional grade heavy duty steel construction

Durable powder coat process

Rolled edges & ribbed discs provide strength & safety

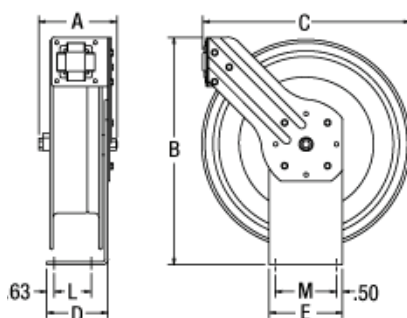

ORDERING INFORMATION

SHF-N-525

Coxreels 3/4" ID Spring Rewind Hose Reel

T series also available:

TSHF-N-650, TSHF-N-635, TSHF-N-575, TSHF-N-550

